

Stepper Motor Driver Speed Board Controller Pulse Signal Generator Module

This is pulse module, can provide 2.5 khz - 68 kHz frequency, control signal for stepper motors. Stepper driver and power supply is required to control stepper motor. If you require a different Frequency Range, you can change C46 capacitance. Power supply: DC 12V. Forward / Reverse motor rotation and start / stop can be controlled by buttons. The motor speed can be controlled by adjusting the potentiometer. Size: 73*51*37MM

www.StepperMotorCanada.ca

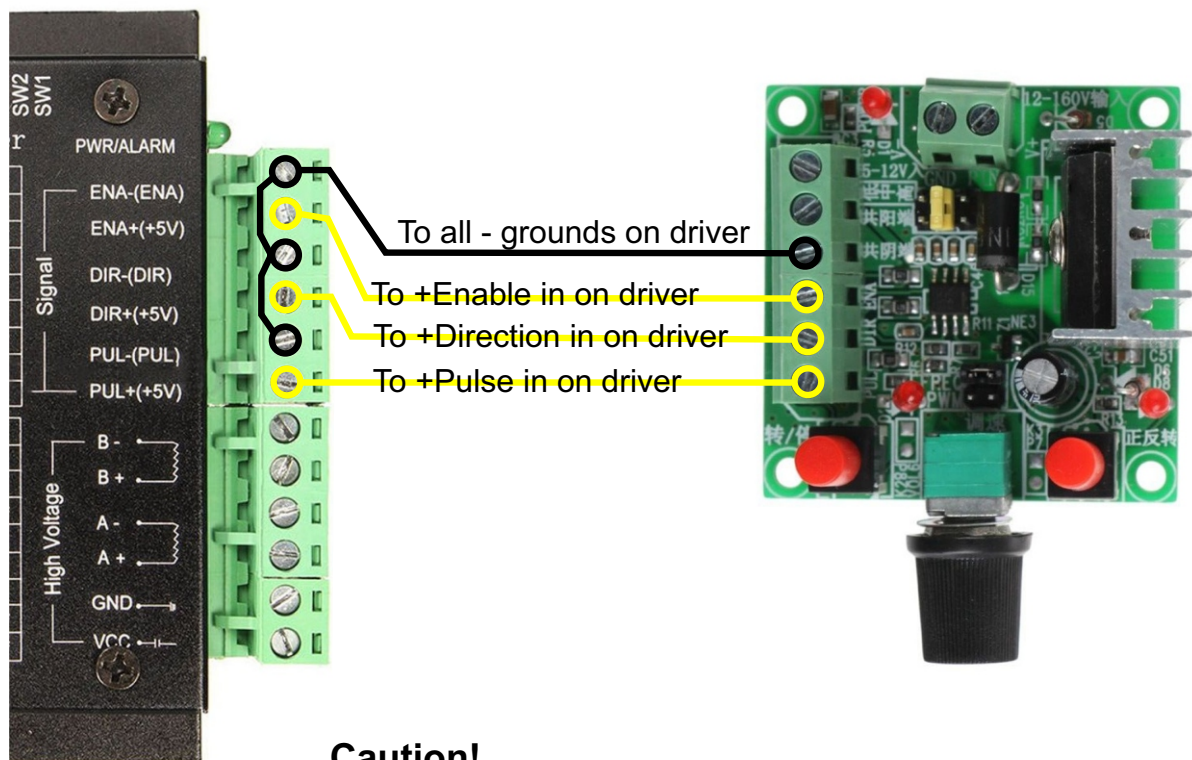
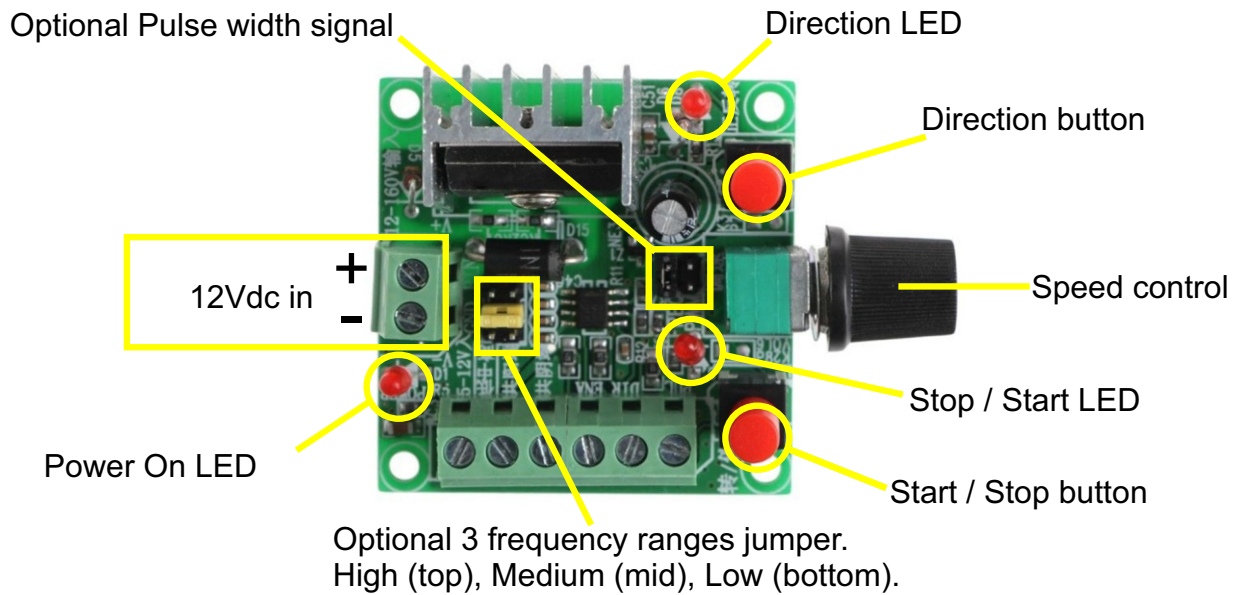

Caution!

Most motor drivers only allow for a 4Vdc-7Vdc signal input only! Using a power supply greater the 12Vdc with this board may cause undesirable voltage levels and cause damage to the driver. Be sure to check with a volt-meter between ground and ENA that voltage levels are correct. If voltage levels are too high, check with your driver manual on how to deal with higher then 5Vdc levels.